



Southwire™

GROUNDING & WIRE ACCESSORIES CATALOG

**BUILT FOR DURABILITY.
BUILT FOR RELIABILITY.
BUILT FOR WORK.™**

SOUTHWIRE.COM

GROUNDING AND WIRE ACCESSORIES

Southwire offers a comprehensive selection of electrical supplies for all grounding and wire accessory applications.

Ground Clamps
Lay-In Lugs and Mechanical Lugs
Compression Lugs
Bonding Kits and Bonding Bridges
Ground Rod Clamps
Grounding Hubs
Split Bolt Connectors
Pigtails, Screws, and Tapes



GROUND CLAMPS FOR ARMORED WIRE

STANDARD - BRONZE



630B

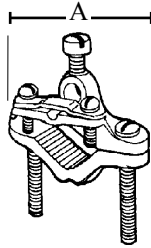

FEATURES

- Fits #8, 6, or 4 bare armored ground wire copper
- Integral clamp securely holds armor

APPLICATIONS

- Use to connect bare or armored copper wire to galvanized steel water pipe or copper tubing

STANDARD MATERIAL

- Bronze
- Screws - Zinc plated steel

CERTIFICATIONS

- cULus

PART #	SIZE	WIRE RANGE	COPPER ROD RANGE	HARDWARE	INNER QTY.	MASTER QTY.	WEIGHT/CASE (LBS.)	A
630B	1/2" - 1"	#8 - #4	1/2" - 1"	ZINC PLATED STEEL	10	100	20	2.30"
630	1-1/4" - 2"	#8 - #4	---	ZINC PLATED STEEL	5	50	30	3.60"
GCA250400	2 1/2"-4"	#8 - #4	---	ZINC PLATED STEEL	---	5	6.25	2.36"
GCA450600	4 1/2"-6"	#8 - #4	---	ZINC PLATED STEEL	---	5	9.40	2.38"

FOR DIRECT BURIAL - BRONZE



630DB

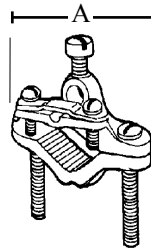

FEATURES

- Fits #8, 6, or 4 bare armored ground wire copper
- Integral clamp securely holds armor

APPLICATIONS

- Use to connect bare or armored copper wire to galvanized steel water pipe or copper tubing

STANDARD MATERIAL

- Bronze
- Screws - Bronze/stainless steel

CERTIFICATIONS

- cULus

PART #	SIZE	WIRE RANGE	COPPER ROD RANGE	HARDWARE	INNER QTY.	MASTER QTY.	WEIGHT/CASE (LBS.)	A
630DB	1/2" - 1"	#8 - #4	1/2" - 1"	BRONZE/STAINLESS STEEL	10	100	20	2.30"

COMBINATION GROUND CLAMPS FOR BARE WIRE

LAY-IN LUG STYLE - BRONZE

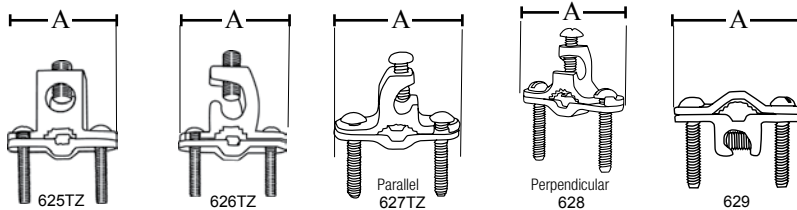
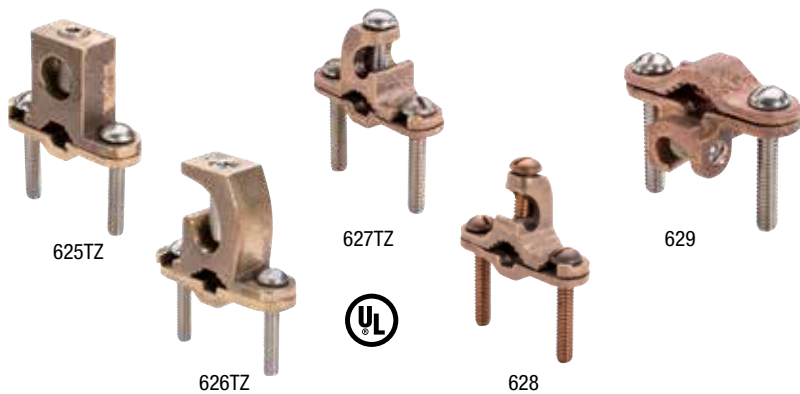

FEATURES

- 625TZ, 626TZ and 629 - Fits 8 STR to 4/0 STR AWG copper
- 627TZ and 628 - Fits 10 SOL to 2 STR AWG copper
- Lay-in style lug for fast and easy installation of ground wires
- Excellent corrosion protection and ground path continuity

APPLICATIONS

- Use to ground bare copper wire to water pipes or rebar
- Approved for direct burial in earth and concrete
- 3/8 to 1" rebar 1/2" to 1" water pipe, copperwater pipe and ground rod

STANDARD MATERIAL

- Bronze

PART #	SIZE	WIRE RANGE	REBAR RANGE	HARDWARE	INNER QTY.	MASTER QTY.	WEIGHT/ CASE (LBS.)	A
625TZ2	1/2" - 1"	#8 - 4/0	3/8" - 1"	STAINLESS STEEL	10	100	30	2.36"
626TZ	1/2" - 1"	#8 - 4/0	3/8" - 1"	STAINLESS STEEL	10	100	30	2.28"
627TZ	1/2" - 1"	#10 - #2	3/8" - 1"	STAINLESS STEEL	10	100	23	2.28"
628	1/2" - 1"	#10 - #2	3/8" - 1"	BRASS	10	100	23	2.28"
629	1/2" - 1"	#8 - 4/0	3/8" - 1"	STAINLESS STEEL	10	100	21	2.28"

GROUND CLAMPS FOR BARE WIRE

FOR DIRECT BURIAL - BRONZE



620DB

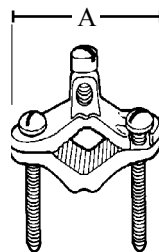

FEATURES

- Fits #10, 8, 6, 4 and 2 STR AWG copper
- Excellent corrosion protection and ground path continuity
- Rotational movement of clamps permit fast removal when required

APPLICATIONS

- Use as a direct burial water pipe ground clamp

STANDARD MATERIAL

- Bronze
- Screws - Bronze/stainless steel

CERTIFICATIONS

- cULus

PART #	SIZE	WIRE RANGE	REBAR RANGE	HARDWARE	INNER QTY.	MASTER QTY.	WEIGHT/ CASE (LBS.)	A
620DB	1/2" - 1"	#10 - #2	1/2" - 1"	BRONZE/STAINLESS STEEL	10	100	20	2.28"

GROUND CLAMPS FOR BARE WIRE

STANDARD - BRONZE



626A

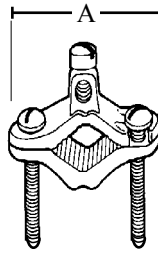

FEATURES

- Fits #10, 8, 6, 4 and 2 STR AWG copper
- Excellent corrosion protection and ground path continuity
- Rotational movement of clamps permit fast removal when required

APPLICATIONS

- Use to ground bare copper wire to galvanized steel water pipes or copper tubing

STANDARD MATERIAL

- Bronze

CERTIFICATIONS

- cULus

PART #	SIZE	WIRE RANGE	REBAR RANGE	HARDWARE	INNER QTY.	MASTER QTY.	WEIGHT/ CASE (LBS.)	A
626A	1/2" - 1"	#10 - #2	5/8" - 3/4"	ZINC PLATED STEEL	10	100	19	2.43
626BS	1/2" - 1"	#10 - #2	5/8" - 3/4"	BRASS	10	100	20	2.43"
L-160-B	1/2" - 1"	#10 - #2	---	BRONZE	25	125	22	2.43"
626B	1-1/4" - 2"	#10 - #2	---	ZINC PLATED STEEL	5	50	19	3.6"
626C	2-1/2" - 4"	#10 - #2	---	ZINC PLATED STEEL	---	10	10	6.35"
626D	4" - 6"	#10 - #2	---	ZINC PLATED STEEL	---	10	10	8.50"

ZINC DIE CAST



620Z



620BP

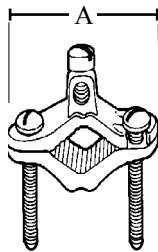

FEATURES

- Fits #10, 8, 6, 4 and 2 STR AWG copper
- Rotational movement of clamps permit fast removal when required

APPLICATIONS

- Use to ground bare copper wire to galvanized steel water pipes or copper tubing
- Zinc construction for use with copper and aluminum
- 3/8 - 1" rebar 1/2" - 1" water pipe, copperwater pipe and ground rod

STANDARD MATERIAL

- Zinc die cast

CERTIFICATIONS

- cULus

PART #	SIZE	WIRE RANGE	REBAR RANGE	HARDWARE	INNER QTY.	MASTER QTY.	WEIGHT/ CASE (LBS.)	A
620Z*	1/2" - 1"	#10 - #2	#8 - #2	ZINC PLATED STEEL	25	250	43	2.22"
620BP**	1/2" - 1"	#10 - #2	#8 - #2	ZINC PLATED STEEL	25	250	43	2.22"

* For copper and aluminum wire

** Non UL

GROUND CLAMPS FOR RIGID CONDUIT WITH CONDUIT HUBS



621TZ

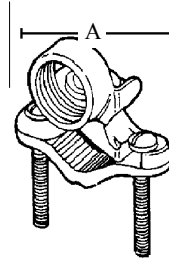

FEATURES

- Assembled with threaded hub for use on Rigid conduit pipe
- Corrosion resistant bronze construction

APPLICATIONS

- Use to ground copper or aluminum wires to water pipes, ground rods, rebar or other structural members, ensuring a positive grounding connection to earth

STANDARD MATERIAL

- Bronze
- Screws - Zinc plated

PART #	SIZE	WIRE RANGE	CONDUIT SIZE	HARDWARE	INNER QTY.	MASTER QTY.	WEIGHT/ CASE (LBS.)	A
621TZ	1/2" - 1"	#8 - #4	1/2"	ZINC PLATED	10	100	26	2.25"
622	1-1/4" - 2"	#8 - #4	1/2"	ZINC PLATED	---	50	35	3.60"
623	2-1/2" - 4"	#8 - #4	1/2"	ZINC PLATED	---	10	15	6.34"
624	5" - 6"	#8 - #4	1/2"	ZINC PLATED	---	10	20	8.50"
621A	1/2" - 1"	#8 - #4	3/4"	ZINC PLATED	5	50	20	2.25"
622A	1-1/4" - 2"	#8 - #4	3/4"	ZINC PLATED	5	50	37	3.60"
623A	2-1/2" - 4"	#8 - #4	3/4"	ZINC PLATED	---	10	12	6.34"
624A	5" - 6"	#8 - #4	3/4"	ZINC PLATED	---	10	21	8.50"
621B	1/2" - 1"	#8 - #4	1"	ZINC PLATED	---	10	9	2.25"
622B	1-1/4" - 2"	#8 - #4	1"	ZINC PLATED	---	10	10	3.60"
623B	2-1/2" - 4"	#8 - #4	1"	ZINC PLATED	---	10	21	6.34"
624B	5" - 6"	#8 - #4	1"	ZINC PLATED	---	10	28	8.50"

GROUND ROD CLAMPS FOR DIRECT BURIAL - BRONZE



412

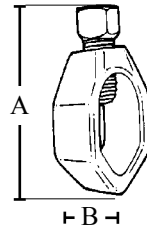

FEATURES

- Approved for direct burial in ground and concrete
- Corrosion resistant bronze construction

APPLICATIONS

- Securely connects a grounding conductor to a drive

STANDARD MATERIAL

- Bronze with stainless steel screw

CERTIFICATIONS

- cULus

PART #	SIZE	INNER QTY.	MASTER QTY.	WEIGHT/ CASE (LBS.)	A	B	WIRE SIZE MIN. MAX.
411	1/2"	100	500	9	1.22"	.75"	10 SOL 2 STR
412	5/8"	100	500	18	1.41"	.90"	10 SOL 2 STR
413	3/4"	---	50	12	1.47"	1"	10 SOL 2 STR

GROUND ROD

NON UL LISTED



FEATURES

- Electrolytic copper coating
- Copper coating will not crack when bent or tear when driven

APPLICATIONS

- Use to connect electrical systems to the ground to safely dissipate electricity to the earth, preventing shorts to connected equipment

STANDARD MATERIAL

- Copper bonded steel

PART #	ROD DIAMETER	ROD LENGTH	MASTER QTY.	WEIGHT/ CASE (LBS.)
GR8C	5/8"	8 FT	10 RODS	60

GROUNDING HUBS



31

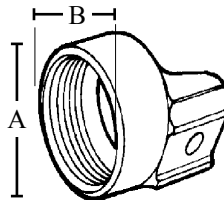

FEATURES

- Corrosion resistant bronze construction assures proper ground continuity

APPLICATIONS

- Use with grounding pipe clamps to connect Rigid conduit to water pipes for grounding

STANDARD MATERIAL

- Bronze

PART #	SIZE	MASTER QTY.	WEIGHT/ CASE (LBS.)	A	B
31	1/2"	25	3	1.15"	1.07"
32	3/4"	25	5	1.30"	1.28"
33	1"	25	6	1.56"	1.50"
H50	1/2"	25	3	1.15"	1.07"
H75	3/4"	25	5	1.30"	1.28"
H100	1"	20	6	1.56"	1.50"
H125	1-1/4"	20	6	1.88"	1.75"

WATER HEATER BONDING KIT



65183240



FEATURES

- Kit includes two brass ground clamps and a copper conductor

APPLICATIONS

- The Southwire water heater grounding kit is designed for residential water heater use, but can be used across any continuity break in residential plumbing. This bonding is essential to maintain continuous ground path

CERTIFICATIONS

- cULus

PART #	WIRE GAUGE SIZE	HUB TRADE SIZE	MASTER QTY.
65183240	#10 SOL/STR – #2 STR	1/2" – 1"	5

ROUND CLAMPS WITH STRAP & HUB



65177740



FEATURES

- Includes bronze casting and copper strap with steel screws

APPLICATIONS

- Southwire ground clamps with strap & hub provides a connection for a ground conductor in rigid conduit to water pipe

CERTIFICATIONS

- cULus

PART #	WIRE GAUGE RANGE	PIPE TRADE SIZE	HUB TRADE SIZE	MASTER QTY.
65177740	#12 SOL – #2 STR	1/2" – 1"	1/2"	10
GCH5010050 *	#12 SOL – #2 STR	1/2" – 1"	1/2"	10
GCH5010075 *	#12 SOL – #2 STR	1/2" – 1"	3/4"	10
GCH5010100 *	#12 SOL – #2 STR	1/2" – 1"	1"	10

*Chicago approved

PARALLEL GROOVE CLAMP

FOR DIRECT BURIAL - BRONZE



65176140

FEATURES

- Serrated grooves provide increased conductor contact and improve mechanical performance
- Dual rated for use on aluminum, ACSR and copper conductors

APPLICATIONS

- The Southwire parallel groove connectors are used for splicing and tapping conductors

STANDARD MATERIAL

- Aluminum

PART #	WIRE GAUGE RANGE	MASTER QTY.	WEIGHT/CASE (LBS.)
65176140	#6 – #1/0	5	1.5
65176240	#2 – #4/0	5	2.7

SPLIT BOLT CONNECTORS

SOLDERLESS - FOR COPPER & COPPERWELD WIRE - COPPER ALLOY



690



FEATURES

- Features copper pressure bar and hex style head
- Highly resistant to corrosion and cracking
- Provides high contact pressure between conductors
- UL 467 suitable for direct burial

APPLICATIONS

- For copper to copper connections including copperweld wire

STANDARD MATERIAL

- Copper alloy

PART #	WIRE SIZE	INNER QTY.	MASTER QTY.	WEIGHT/ CASE (LBS.)	MAXIMUM RUN TO MINIMUM TAP	
					RUN	TAP
690	#10	100	1000	2	16 STR	10 STR
691TZ	#8	100	1000	3	8 STR 8 SOL	16 STR 16 SOL
692TZ	#6	100	1000	5	6 SOL	16 SOL
693	#6	50	500	8	6 STR 6 SOL	14 STR 14 SOL
694	#4	50	500	8	4 STR 4 SOL	14 STR 14 SOL
695	#2	50	500	11	2 STR 2 SOL	14 STR 14 SOL
696	1/0	50	500	8	1/0 STR 1/0 SOL	14 STR 14 SOL
697	2/0	25	250	7	2/0 STR 2/0 SOL	14 STR 14 SOL
698TZ	3/0	25	25	8	3/0 STR 3/0 SOL	8 STR 8 SOL
699TZ	4/0 - 250 MCM	5	50	10	250 STR	8 STR
700TZ	350 MCM	---	6	5	350 STR	1/0 STR
701TZ	500 MCM	---	6	5	500 STR	2/0 STR
703TZ	1000 MCM	---	4	10	500 MCM	1000 MCM

GROUNDING AND WIRE ACCESSORIES

SPLIT BOLT CONNECTORS

WITH SPACER BAR



792



FEATURES

- Electro tin-plated, high strength copper alloy with spacer
- Spacer separates dissimilar conductors and provides long contact length that prevents high pressure point contacts between run and tap conductors

APPLICATIONS

- For copper to copper, copper to aluminum, aluminum to aluminum
- Usable with aluminum connector, however not UL listed for that application

STANDARD MATERIAL

- Copper alloy

STANDARD FINISH

- Electro-tin plated

PART #	WIRE SIZE	INNER QTY.	MASTER QTY.	WEIGHT/ CASE (LBS.)	MAXIMUM RUN TO MINIMUM TAP	
FOR COPPER TO COPPER, COPPER TO ALUMINUM, ALUMINUM TO ALUMINUM (2)						
792	#6	100	1000	7	6 STR 6 SOL	10 STR 10 SOL
794	#3	---	100	11	4 STR 4 SOL	10 STR 10 SOL
795	#2	---	50	15	2 STR 2 SOL	14 STR 14 SOL
FOR COPPER TO COPPER (1,2)						
796	1/0	---	25	10	1/0 STR 1/0 SOL	10 STR 10 SOL
797	2/0	---	25	5	2/0 STR 2/0 SOL	8 STR 8 SOL
799	4/0 – 250 MCM	5	50	15	250 STR	8 STR
801TZ	500 MCM	---	6	7	500 STR	2/0 STR
803TZ	1000 MCM	---	2	6	350 MCM	1000 MCM

(1) Usable with aluminum conductor, however not UL listed for that application

(2) When making connections with aluminum or ACSR (Aluminum conductor steel reinforced) make certain to use an oxide inhibiting compound such as antiox featured on page 14-23

MEIBB™ BONDING BRIDGE



MEIBB



PART #	WIRE GAUGE SIZE	TERMINATING POINTS	MATERIAL	INNER QTY.	MASTER QTY.
MEIBB*	#4 SOL – #10 SOL	6	ZINC DIE-CAST	1	6

*Southwire Exclusive

FEATURES

- Conventional Intersystem Bonding Bridge includes mounting holes and weather-resistant PVC cover
- MEIBB™ Bonding Bridge mounts to enclosures, conduit bodies and inline with conduit (1/2" Trade Size) It is also gang able allowing for multiple bridge runs to be made and includes an inspection window to give you a quick view of your connection points

APPLICATIONS

- Southwire intersystem bonding bridges are used to bond all telephone, cable and satellite grounding conductors at a single location. Traditional PVC covered "mount-to-house" styles and Southwire's innovative MEIBB™ Bonding Bridge

CERTIFICATIONS

- cULus

BONDING BRIDGE

ZINC DIE CAST OR BRONZE



813



813-B

FEATURES

- Meets 2008 NEC article 250.94
- Stainless steel hardware
- Lay-in style lug for easy installations
- Mounts directly to grounding electrode conductor
- Robust one-piece extruded aluminum construction
- Zinc is tin plated for maximum conductivity
- Includes weather resistant polycarbonate snap on cover
- Available in zinc and bronze

APPLICATIONS

- Used to bond all utility conductors to a single location in residential and small commercial facilities as required by Article 250.94 of the 2008 NEC guide

CONDUCTIVE RANGE

- 6-2 AWG grounding electrode conductor
- 14-4 AWG bonding conductors

STANDARD MATERIAL

- Zinc die cast - 813
- Bronze - 813B
- Polycarbonate cover
- 65181740 PVC Cover

PART #	MATERIAL	INNER QTY.	MASTER QTY.	WEIGHT/ CASE (LBS.)	CONDUCTOR RANGE
813	ZINC	1	10	5	6-2 AWG GROUNDING ELECTRODE CONDUCTOR 14-4 AWG BONDING CONDUCTORS
813B	BRONZE	1	10	6	6-2 AWG GROUNDING ELECTRODE CONDUCTOR 14-4 AWG BONDING CONDUCTORS

GROUNDING AND WIRE ACCESSORIES

MULTITAP CONNECTORS



65254740



PART #	WIRE GAUGE SIZE	HEX DRIVER SIZE	INNER QTY.	MASTER QTY.
65254740	2/0 STR – #6 STR	3/16"	1	5

FEATURES

- Dual-rated for use with Al and Cu conductors
- Oxide Inhibitor Pre-installed

APPLICATIONS

- Southwire multitap line of connectors makes inspectable, UL 486B listed and CSA certified, clear multitap is dual rated AL9CU for stranded copper or aluminum applications

STANDARD MATERIAL

- Aluminum with Plastisol Insulation

SOLDERLESS LUGS

SINGLE HOLE - OFFSET TANG - COPPER



820TZ

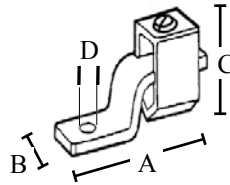

FEATURES

- Unique pressure bar provides solid grip between conductor and terminal
- Hole for offset tang mounting

APPLICATIONS

- Terminates an electrical conductor to facilitate mechanical connection

STANDARD MATERIAL

- Copper
- Steel screw

PART #	AMP RATING	RECOMMENDED TORQUE IN LBS.	BOLT SIZE	MASTER QTY.	WEIGHT/CASE (LBS.)	WIRE RANGE MIN. – MAX.	A	B	C	D
820TZ	25	20	1/8"	250	3	#14 – #10	1"	.3125"	.6875"	.125"
821	35-50	45	3/16"	250	6	#14 – #6	1.1875"	.375"	.75"	.1875"
822	70	50	1/4"	200	6	#2 – #8	1.3125"	.50"	.8125"	.25"
823	70-90	50	1/4"	200	9	#2 – #6	1.5313"	.50"	1"	.25"
824	125	50	1/4"	100	11	#8 – 1/0	1.9688"	.625"	1.375"	.25"
825TZ	175	124	3/8"	25	3	#4 – 3/0	2.1875"	.75"	1.5625"	.375"
826TZ	225	204	5/16"	25	6	#6 – 4/0	2.625"	1"	2"	.3125"
827TZ	300	325	3/8"	20	10	1/0 – 350 MCM	3.1875"	1"	2.625"	.375"
828	400	375	3/8"	10	7	4/0 – 500 MCM	4.25"	1.50"	2.75"	.375"
829	650	500	1/2"	4	7	600 MCM – 100 MCM	4.625"	2"	3.6875"	.50"

LAY-IN LUGS

DUAL RATED - ALUMINUM



810TZ

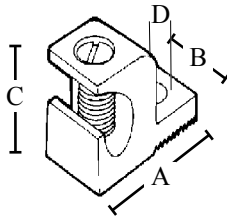

FEATURES

- 90°C temperature rating
- Single hole assembly
- Provides positive grounding points in load centers or other enclosures

APPLICATIONS

- For use with copper or aluminum conductor
- Terminates an electrical conductor to facilitate mechanical connection

STANDARD MATERIAL

- Aluminum
- Steel screw

CERTIFICATIONS

- cULus

PART #	RECOMMENDED TORQUE IN LBS.	BOLT SIZE	INNER QTY.	MASTER QTY.	WEIGHT/ CASE (LBS.)	WIRE RANGE MIN. – MAX.	A	B	C	D
810TZ	35	1/4"	25	250	6	#14 – #4	1.13"	.39"	.79"	.22"
811TZ	50	3/8"	---	100	7	#14 – 1/0	1.65"	.63"	1.10"	.26"
812TZ	275	9/16"	---	50	10	6 – 250 MCM	2.19"	.89"	1.72"	.33"

LAY-IN LUGS

COPPER



1/0-8CL

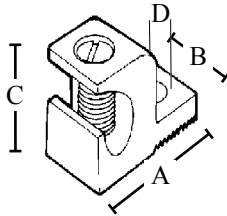

FEATURES

- 90°C temperature rating
- Single hole assembly
- Provides positive grounding points in load centers or other enclosures

APPLICATIONS

- For use with copper conductor
- Terminates an electrical conductor to facilitate mechanical connection

STANDARD MATERIAL

- Copper
- Steel screw

PART #	WIRE GAUGE RANGE	MASTER QTY.	A	B	C
65175540	#4-#14	10	1"	3/8"	13/16"
1/0-14CL	#14 - 1/0	100	1-1/2"	5/8"	1-1/8"
3/0-6CL	#6 – 3/0	50	2"	13/16"	1-1/2"

SOLAR LAY-IN LUGS

DUAL RATED



810DB

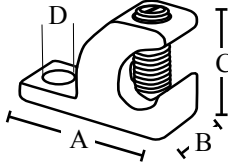

FEATURES

- Specifically designed for solar panels
- Manufactured from high strength pure electrolytic copper for superior conductivity
- Open face design allows for fast lay-in of the conductor, eliminating the need for cutting or breaking
- Suitable for direct burial/outdoor use
- Excellent corrosion resistance

APPLICATIONS

- UL 467 listed for direct burial in earth or concrete
- Corrosion resistant
- 4 AWG STR through 14 AWG STR/SOL
- Commonly used for solar panel grounding

STANDARD MATERIAL

- Body - Copper
- Hardware - Stainless steel screw

STANDARD FINISH

- Tin plated

CERTIFICATIONS

- cULus

PART #	BOLT SIZE	INNER QTY.	MASTER QTY.	WEIGHT/ CASE (LBS.)	WIRE RANGE MIN. - MAX.	A	B	C	D
810DB	1/4" - 20	100	1000	47	#14 - #4	1.125"	.375"	.875"	.1875"

MECHANICAL LUGS

SINGLE - ALUMINUM



805TZ

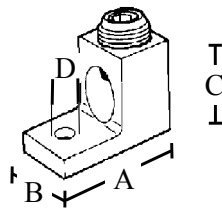

FEATURES

- 90°C temperature rating
- Single hole assembly
- Up to 600 lbs. torque
- High strength aluminum alloy provides low contact resistance

APPLICATIONS

- For use with copper conductor
- Terminates an electrical conductor to facilitate mechanical connection

STANDARD MATERIAL

- Aluminum
- Steel screw

CERTIFICATIONS

- cULus

PART #	RECOMMENDED TORQUE IN LBS.	BOLT SIZE	INNER QTY.	MASTER QTY.	WEIGHT/ CASE (LBS.)	WIRE RANGE MIN. - MAX.	A	B	C	D
805TZ	35	1/4"	100	1000	14	#14 - #6	1.0625"	.50"	.50"	.25"
806TZ	50	1/4"	100	1000	19	#14 - #2	1.1563"	.50"	.5625"	.25"
807TZ	180	1/4"	---	50	2	#14-1/0	1.4088"	.625"	.8125"	.25"
808TZ	120	1/4"	---	50	2	#14-2/0	1.4688"	.625"	.8125"	.25"
809TZ*	325	5/16"	---	25	3	#6 - 4/0	2"	1"	1.0625"	.3125"
1810*	325	5/16"	10	100	10	#6 - 300 MCM	2"	1"	1.0625"	.3125"
817*	325	5/16"	---	25	4	#6 - 350 MCM	2.25"	1.125"	1.25"	.3125"
818*	375	5/16"	10	100	24	#4 - 500 MCM	2.75"	1.125"	1.50"	.375"
1818*	500	3/8"	5	50	15	#9 - 600 MCM	2.75"	1.375"	1.50"	.375"
819TZ*	500	3/8"	---	5	2	350 MCM - 800 MCM	3.50"	1.50"	1.75"	.50"

*For copper and aluminum

MECHANICAL LUGS

DOUBLE - DUAL RATED - ALUMINUM



2807TZ

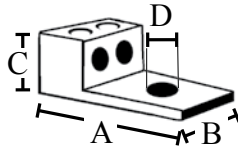

FEATURES

- Two conductor design
- Fast and easy installation
- 90°C temperature rating

APPLICATIONS

- For use with copper or aluminum conductor
- Terminates an electrical conductor to facilitate mechanical connection

STANDARD MATERIAL

- Aluminum
- Steel screw

CERTIFICATIONS

- cULus

PART #	RECOMMENDED TORQUE IN LBS.	INNER QTY.	MASTER QTY.	WEIGHT/CASE (LBS.)	WIRE RANGE MIN. – MAX.	A	B	C	D
2807TZ	50	10	100	23	#14 – 1/0	1.50"	1.1875"	.8125"	.25"
2808TZ	50	10	100	24	#14 – 2/0	1.50"	1.1875"	.8125"	.25"
2809	275	10	100	26	#6 – 250 MCM	2.5625"	1.625"	1.1875"	.375"
2817TZ	275	4	40	20	#6 – 350 MCM	2.875"	2.9375"	1.25"	.50"
2818	375	6	60	19	#2 – 600 MCM	3.125"	2.375"	1.5625"	.50"
2819	375	6	60	14	300 MCM – 800 MCM	3.50"	2.8125"	1.6875"	.625"

COMPRESSION LUG SPLICES

LONG BARREL

FEATURES

- Seamless, high conductivity copper tubing, suitable for heavy duty applications
- Tin-plated to provide corrosion resistance
- Color coded

APPLICATIONS

- Suitable for use at voltages up to 35 KV provided connector is properly taped
- 5 KV is the maximum voltage in all bare splice applications

STANDARD MATERIAL

- Copper

STANDARD FINISH

- Tin plated



3101TZ

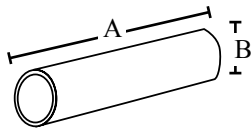

PART #	WIRE SIZE	COLOR CODE	INNER QTY.	MASTER QTY.	WEIGHT/ CASE (LBS.)	A	B
3101TZ	#8	RED	100	1000	22	1.75"	.20"
3102	#6	BLUE	100	1000	22	1.75"	.20"
3103	#4	GRAY	100	1000	26	1.75"	.25"
3105TZ	#2	BROWN	50	500	21	1.90"	.31"
3106	1/0	PINK	25	250	19	2.20"	.39"
3107	2/0	BLACK	25	250	20	2.25"	.44"
3108	3/0	ORANGE	25	250	23	2.25"	.49"
3109	4/0	PURPLE	25	250	32	2.75"	.55"
3109A	250 MCM	YELLOW	10	100	20	3.25"	.59"
3109B	300 MCM	WHITE	10	100	23	3.50"	.66"
3110TZ	350 MCM	RED	10	100	28	3.75"	.70"
3110A	400 MCM	BLUE	10	100	32	3.75"	.76"
3111TZ	500 MCM	BROWN	5	50	25	4.25"	.83"
3111A	600 MCM	GREEN	5	50	34	4.50"	.93"
3112	750 MCM	BLACK	5	50	41	4.75"	1.03"

SHORT BARREL



3301

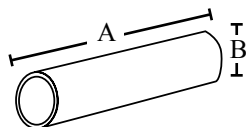

PART #	WIRE SIZE	COLOR CODE	INNER QTY.	MASTER QTY.	WEIGHT/ CASE (LBS.)	A	B
3301	#8	RED	100	1000	12	.90"	.17"
3302	#6	BLUE	100	1000	14	1"	.20"
3303	#4	GRAY	100	1000	16	1"	.25"
3305	#2	BROWN	100	1000	27	1.25"	.31"
3305A	#1	GREEN	50	500	23	1.60"	.39"
3306	1/0	PINK	50	500	26	1.75"	.44"
3307	2/0	BLACK	50	500	29	1.75"	.49"
3308	3/0	ORANGE	50	500	34	1.90"	.55"
3309	4/0	PURPLE	25	250	23	2"	.59"
3309A	250 MCM	YELLOW	25	250	29	2.10"	.66"
3310	350 MCM	RED	20	200	31	2.10"	.70"
3310A	400 MCM	BLUE	10	100	21	2.30"	.76"
3311	500 MCM	BROWN	10	100	29	2.50"	.83"
3311A	600 MCM	GREEN	5	50	20	2.50"	.93"
3312	750 MCM	BLACK	5	50	29	3.21"	1.03"

COMPRESSION LUGS

ONE HOLE - SHORT BARREL



2901

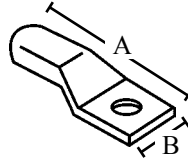

FEATURES

- Ideal for direct burial in earth or concrete and grounding applications
- Produced from high conductivity copper tubing and suitable for heavy duty applications
- Tin-plated to provide corrosion resistance
- Color coded

APPLICATIONS

- Listed for 35 KV maximum when properly installed

STANDARD MATERIAL

- Copper

STANDARD FINISH

- Tin plated

PART #	WIRE SIZE	COLOR CODE	BOLT SIZE	INNER QTY.	MASTER QTY.	WEIGHT/CASE (LBS.)	A	B
2901	#8	RED	10	100	1000	14	1.20"	.42"
2901A	#8	RED	1/4"	100	1000	13	1.20"	.42"
2902	#6	BLUE	1/4"	100	1000	17	1.50"	.42"
2902A	#6	BLUE	5/16"	100	1000	17	1.50"	.42"
2903	#4	GRAY	1/4"	100	1000	20	1.50"	.71"
2903A	#4	GRAY	5/16"	100	1000	18	1.50"	.71"
2903B	#4	GRAY	3/8"	100	1000	18	1.50"	.71"
2905	#2	BROWN	3/8"	100	1000	28	1.80"	.83"
2905A	#1	GREEN	3/8"	100	1000	35	1.83"	.67"
2906	1/0	PINK	3/8"	50	500	21	1.83"	.74"
2907	2/0	BLACK	3/8"	50	500	32	2.24"	.81"
2907A	2/0	BLACK	1/2"	50	500	29	2.24"	.81"
2908	3/0	ORANGE	3/8"	25	250	21	2.36"	.90"
2909	4/0	PURPLE	1/2"	25	250	24	2.36"	1"
2909A	250 MCM	YELLOW	1/2"	25	250	30	2.48"	1.09"
2909B	300 MCM	WHITE	1/2"	25	250	33	2.49"	1.19"
2910	350 MCM	RED	1/2"	20	200	33	2.61"	1.28"
2910A	400 MCM	BLUE	1/2"	10	100	24	3.95"	1.39"
2911	500 MCM	BROWN	5/8"	10	100	33	3.28"	1.54"
2911A	600 MCM	GREEN	5/8"	5	50	24	3.50"	1.72"
2912	750 MCM	BLACK	5/8"	5	50	35	4.37"	1.90"

COMPRESSION LUGS

TWO HOLE - SHORT BARREL



2921

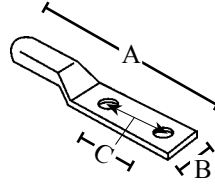

FEATURES

- Produced from high conductivity copper tubing and suitable for heavy duty applications
- Tin-plated to provide corrosion resistance
- Color coded

APPLICATIONS

- Listed for 35 KV maximum when properly installed
- Ideal for direct burial in earth or concrete and grounding applications

STANDARD MATERIAL

- Copper

STANDARD FINISH

- Tin plated

PART #	WIRE SIZE	COLOR CODE	BOLT SIZE	INNER QTY.	MASTER QTY.	WEIGHT/ CASE (LBS.)	A	B	C = HOLE SPACING
2921	#8	RED	10	100	1000	20	2.50"	.45"	.625"
2922	#6	BLUE	1/4"	100	1000	23	2.56"	.45"	.625"
2923	#4	GRAY	1/4"	100	1000	28	2.34"	.50"	.625"
2925	#2	BROWN	5/16"	50	500	26	2.58"	.61"	.75"
2925A	#2	BROWN	3/8"	50	500	26	3.05"	.61"	.75"
2926	1/0	PINK	5/16"	25	250	20	3.14"	.75"	.875"
2927	2/0	BLACK	3/8"	25	250	23	3.24"	.83"	1.75"
2927A	2/0	BLACK	1/2"	25	250	31	4.17"	.83"	1.75"
2928	3/0	ORANGE	1/2"	25	250	36	4.25"	.91"	1.75"
2929	4/0	PURPLE	1/2"	20	200	36	4.28"	1.02"	1.75"
2929A	250 MCM	YELLOW	1/2"	10	100	24	4.41"	1.11"	1.75"
2929B	300 MCM	WHITE	1/2"	10	100	26	4.53"	1.24"	1.75"
2930	350 MCM	RED	1/2"	5	50	17	4.53"	1.24"	1.75"
2931	400 MCM	BLUE	1/2"	5	50	20	4.81"	1.34"	1.75"
2932	500 MCM	BROWN	1/2"	5	50	27	4.88"	1.52"	1.75"
2933	600 MCM	GREEN	3/8"	5	50	35	4.49"	1.73"	1.75"
2934	750 MCM	BLACK	1/2"	5	50	44	4.79"	1.89"	1.75"

COMPRESSION LUGS

ONE HOLE - LONG BARREL



3001

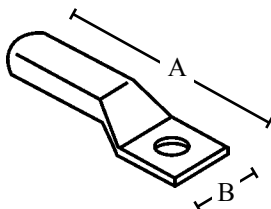

FEATURES

- Produced from high conductivity copper tubing and suitable for heavy duty applications
- Tin-plated to provide corrosion resistance
- Color coded

APPLICATIONS

- Listed for 35 KV maximum when properly installed
- Ideal for direct burial in earth or concrete and grounding applications

STANDARD MATERIAL

- Copper

STANDARD FINISH

- Tin plated

PART #	WIRE SIZE	COLOR CODE	BOLT SIZE	INNER QTY.	MASTER QTY.	WEIGHT/CASE (LBS.)	A	B
3001	#8	RED	1/4"	100	1000	16	1.70"	.38"
3002	#6	BLUE	1/4"	100	1000	20	1.77"	.38"
3003	#4	GRAY	1/4"	100	1000	23	1.77"	.50"
3005	#2	BROWN	3/8"	50	500	18	2"	.67"
3005A	#1	GREEN	3/8"	50	500	23	2.09"	.67"
3006	1/0	PINK	3/8"	50	500	29	2.20"	.75"
3007	2/0	BLACK	3/8"	25	250	20	2.80"	.75"
3008	3/0	ORANGE	3/8"	25	250	25	2.80"	.87"
3008A	3/0	ORANGE	1/2"	25	250	23	2.80"	.87"
3009	4/0	PURPLE	1/2"	25	250	28	2.80"	1"
3009A	250 MCM	YELLOW	1/2"	20	200	30	3.03"	1.13"
3009B	300 MCM	WHITE	1/2"	10	100	20	3.39"	1.13"
3010TZ	350 MCM	RED	1/2"	10	100	24	3.50"	1.13"
3010A	400 MCM	BLUE	1/2"	10	100	30	3.74"	1.34"
3011TZ	500 MCM	BROWN	1/2"	5	50	23	4.02"	1.50"
3011A	600 MCM	GREEN	5/8"	5	50	29	4.25"	1.75"
3012TZ	750 MCM	BLACK	5/8"	5	50	41	5.16"	1.87"

COMPRESSION LUGS

TWO HOLE - LONG BARREL



3201TZ

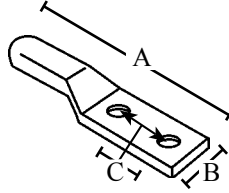

FEATURES

- Produced from high conductivity copper tubing and suitable for heavy duty applications
- Tin-plated to provide corrosion resistance
- Color coded

APPLICATIONS

- Listed for 35 KV maximum when properly installed
- Ideal for direct burial in earth or concrete and grounding applications

STANDARD MATERIAL

- Copper

STANDARD FINISH

- Tin plated

PART #	WIRE SIZE	COLOR CODE	BOLT SIZE	INNER QTY.	MASTER QTY.	WEIGHT/ CASE (LBS.)	A	B	C = HOLE SPACING
3201TZ	#8	RED	1/4"	100	1000	23	2.19"	.42"	.625"
3202TZ	#6	BLUE	1/4"	100	1000	26	2.19"	.42"	.625"
3203	#4	GRAY	1/4"	100	1000	31	2.36"	.49"	.625"
3205TZ	#2	BROWN	1/2"	50	500	39	4.25"	.807"	1.75"
3206	1/0	PINK	1/2"	25	250	32	4.40"	.74"	1.75"
3207	2/0	BLACK	3/8"	25	250	34	4.61"	.81"	1.75"
3208	3/0	ORANGE	1/2"	20	200	33	4.69"	.90"	1.75"
3209	4/0	PURPLE	1/2"	10	100	21	4.72"	1"	1.75"
3209A	250 MCM	YELLOW	1/2"	10	100	27	4.95"	1.09"	1.75"
3209B	300 MCM	WHITE	1/2"	10	100	31	5.31"	1.19"	1.75"
3210	350 MCM	RED	1/2"	10	100	37	5.39"	1.28"	1.75"
3210A	400 MCM	BLUE	1/2"	5	50	23	5.47"	1.39"	1.75"
3211	500 MCM	BROWN	1/2"	5	50	32	5.79"	1.72"	1.75"
3211A	600 MCM	GREEN	1/2"	5	50	41	5.79"	1.72"	1.75"
3212	750 MCM	BLACK	1/2"	5	50	56	6.30"	1.90"	1.75"

GREEN PIGTAIL

WITH SLOTTED HEX GROUND SCREW



50

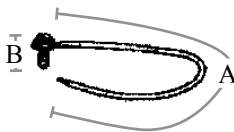

FEATURES

- Plated green to ensure proper identification

APPLICATIONS

- Use to ground receptacles to steel boxes

STANDARD MATERIAL

- Copper wire/zinc plated ground screw

PART #	SIZE	INNER QTY.	MASTER QTY.	WEIGHT/ CASE (LBS.)	A	B
50	7" 14GA. SOLID GREEN	100	1000	23	7"	10-32 x 3/8"
49	7-1/2" 12GA. SOLID GREEN	100	1000	24	7-1/2"	10-32 x 3/8"
49L	10" 12GA. SOLID GREEN	100	1000	32	10"	10-32 x 3/8"
49XL	7" 12GA. SOLID GREEN	100	800	28	12"	10-32 x 3/8"
50A	7-1/2" 10GA. SOLID GREEN	100	100	30	7-1/2"	10-32 x 3/8"

GREEN GROUNDING PIGTAILS



PTST14GN



PTST12GN-NGS

FEATURES

- 12 AWG & 14 AWG green grounding pigtails

APPLICATIONS

- Southwire Grounding Pigtails feature THHN lead wires that are convenient for grounding applications in electrical boxes

PART #	WIRE GAUGE	LENGTH	COLOR	ATTACHMENT TYPE	INNER QTY.	MASTER QTY.
PTST14GN	14 AWG STR	8"	GREEN	FLANGED SPADE TERMINAL & CAPTIVE 10-32 GREEN SCREW	---	100
PTST12GN-NGS	12 AWG STR	8"	GREEN	FLANGED SPADE TERMINAL & PRESTRIPPED 5/8"	---	100
PTST12GN	12 AWG STR	8"	GREEN	FLANGED SPADE TERMINAL & CAPTIVE 10-32 GREEN SCREW	---	100
PTS012GN-S	12 AWG SOL	8"	GREEN	STRIPPED 5/8" ON BOTH ENDS	---	100

POWER PIGTAIL LEADS WITH STRIP AND STRIP TERMINAL



FEATURES

- 8" solid power pigtail leads
- *Both Ends Prestripped 5/8"

APPLICATIONS

- Southwire's Power Pigtails feature THHN lead wires that are convenient for grounding applications in electrical boxes

PART #	WIRE GAUGE SIZE	LENGTH	COLOR	MASTER QTY.
PTS014BK	14 AWG SOL	8"	BLACK	100
PTS012BK	12 AWG SOL	8"	BLACK	100
PTS012RD	12 AWG SOL	8"	RED	100
PTS012WH	12 AWG SOL	8"	WHITE	100

POWER PIGTAIL LEADS WITH FORK TERMINAL



FEATURES

- 8" stranded power pigtail leads
- *Includes flanged spade terminal and prestripped 5/8"

APPLICATIONS

- Southwire's Grounding Pigtails feature THHN lead wires that are convenient for grounding applications

PART #	WIRE GAUGE	LENGTH	COLOR	MASTER QTY.
PTST14BK	14 AWG STR	8"	BLACK	100
PTST12BK	12 AWG STR	8"	BLACK	100
PTST12RD	12 AWG STR	8"	RED	100
PTST12WH	12 AWG STR	8"	WHITE	100

GROUND SCREWS



GS



GSST

PART #	THREAD SIZE	SCREW LENGTH	MATERIAL	MASTER QTY.
GS	10-32	3/8"	GREEN PASSIVATED	100
GSST *	10-32	3/8"	GREEN PASSIVATED	100

*Self-Tapping, Tri-Drive Hex Washer Head

FEATURES

- The head on the grounding screws is compatible with Hex, Phillips, slotted and #2 Robertson drive styles
- Hole-finding designed screw tip

APPLICATIONS

- Southwire combination grounding screws are used in electrical boxes and on electrical devices for connecting ground conductors

STANDARD MATERIAL

- Steel

GREEN GROUND CLIP

STEEL



GC

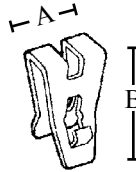

FEATURES

- Holds 14 and 12 GA. copper and aluminum wire

APPLICATIONS

- Connects NM cable to outlet box
- Connects grounding jumper from a receptacle to an outlet

STANDARD MATERIAL

- Steel

PART #	WIRE GAUGE SIZE	MASTER QTY.	WEIGHT/CASE (LBS.)	A	B
GC	#14 & #12	100	.3	.24"	.65"

HEAVY DUTY CABLE LUBRICANT



1200TZ



FEATURES

- Water based gel
- Non-toxic
- Non-flammable
- Cleans easily off with just water

APPLICATIONS

- Compatible with all cables
- Helps avoid wear and abrasion damage
- UL Listed

PART #	SIZE	MASTER QTY.	WEIGHT/CASE (LBS.)
1200TZ	1 QUART	12	13
1201TZ	1 GALLON	4	25
1202TZ	1 GALLON PAIL	1	30

ANTIOX CONTACT COMPOUND



1209

PART #	SIZE	MASTER QTY.	WEIGHT/ CASE (LBS.)
1209	4 OUNCE	12	3
1210	8 OUNCE	12	6

FEATURES

- Prevents oxidation of aluminum to aluminum and aluminum to copper electrical conductors
- Non-conductive

APPLICATIONS

- Use for all types of connections, split bolt and wire connectors

PLASTIC ELECTRICAL TAPE

7 MIL. - PVC



860T

PART #	SIZE	COLOR	UNIT CARTON	MASTER QTY.	WEIGHT/ CASE (LBS.)
860T	3/4" x 60'	BLACK	10	200	37
866T	3/4" x 66'	BLACK	10	100	20
866BLU	3/4" x 66'	BLUE	10	100	20
866BRN	3/4" x 66'	BROWN	10	100	20
866GRN	3/4" x 66'	GREEN	10	100	20
866GRY	3/4" x 66'	GRAY	10	100	20
866ORN	3/4" x 66'	ORANGE	10	100	20
866RED	3/4" x 66'	RED	10	100	20
866WHT	3/4" x 66'	WHITE	10	100	20
866YEL	3/4" x 66'	YELLOW	10	100	20

FEATURES

- Premium grade for electrical work
- Can be used in residential maintenance
- 600v rated

APPLICATIONS

- Insulates and protects wires and connectors; protects splices and filler compounds
- Holds high voltage electrical appliances

STANDARD MATERIAL

- PVC

CAUTION TAPE

NON- DETECTABLE



1591



1593

FEATURES

- Traditional and familiar design
- Strong and durable polyethylene construction

APPLICATIONS

- High visibility tape designed as a hazard alert

STANDARD MATERIAL

- PVC

PART #	SIZE	MIL.	COLOR /TYPE	MASTER QTY.	WEIGHT/ CASE (LBS.)
1591	3" x 300'	4	YELLOW "CAUTION"	16	16
1592	3" x 1000'	2	YELLOW "CAUTION"	8	40
1593	3" x 200'	4	RED "CAUTION BURIED ELECTRIC LINE BELOW"	16	16
1594	3" x 1000'	4	RED "CAUTION BURIED ELECTRIC LINE BELOW"	8	40
1595	6" x 1000'	4	RED "CAUTION BURIED ELECTRIC LINE BELOW"	4	60

DETECTABLE



1596

FEATURES

- Instantly recognizable as a hazard caution
- Strong and durable polyethylene construction
- Can be easily located with a metal detector

APPLICATIONS

- High visibility tape designed as a hazard alert

STANDARD MATERIAL

- Foil bonded PVC

PART #	SIZE	MIL.	COLOR /TYPE	MASTER QTY.	WEIGHT/ CASE (LBS.)
1596	2" x 1000'	5	RED "CAUTION BURIED ELECTRIC LINE BELOW"	12	60
1597	3" x 1000'	5	RED "CAUTION BURIED ELECTRIC LINE BELOW"	8	64
1598	6" x 1000'	5	RED "CAUTION BURIED ELECTRIC LINE BELOW"	4	64

WARNING TAG



65180940

PART #	MATERIAL	INNER QTY.	MASTER QTY.
65180940	ALUMINUM	---	50

FEATURES

- Corrosion-resistant aluminum construction
- Stamped markings are permanent
- Pre-drilled hole for easy mounting

APPLICATIONS

- Southwire grounding code tags are used to mark electrical service for safety

ELECTRICIANS SCREW KIT



65177140

FEATURES

- 120-count screw kits
- Compartmentalized storage case included
- Includes 2/3", 7/8", 1", 1-1/4", 1-5/8", and 2" screws

APPLICATIONS

- Southwire electrician screw kits contain assorted sizes and lengths of commonly used electrical machine screws

STANDARD MATERIAL

- Steel

STANDARD FINISH

- Zinc

PART #	THREAD SIZE	SCREW TYPE	SCREW SIZES	QTY OF SCREWS	MASTER QTY.
65177140	6-32	SLOTTED FLAT HEAD SCREWS	2/3", 7/8", 1", 1-1/4", 1-5/8", 2"	20 OF EACH SIZE	5
65177240	8-32	SLOTTED FLAT HEAD SCREWS	2/3", 7/8", 1", 1-1/4", 1-5/8", 2"	20 OF EACH SIZE	5



Southwire™

GROUNDING & WIRE ACCESSORIES CATALOG

get social with us:



/SOUTHWIRETOOLS



/SOUTHWIRE-COMPANY



@SOUTHWIRETOOLS



@SOUTHWIRE

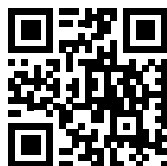

SCAN TO LEARN MORE

WWW.SOUTHWIRE.COM | 1-855-SWT00LS

All Trademarks or Registered Trademarks (TM/®) are owned or licensed by Southwire Company.
Any other TM/®- Trademark or Registered Trademark of Southwire Company.